



INSTALLATION INSTRUCTIONS

Accessory

QUICK SHIFTER
P/N 08U70-MKK-D01

Application

CRF1000A/A2

Publication No.

MII

Issue Date

July 2019

Honda Dealer: Please give a copy of these instructions to your customer.

PARTS LIST

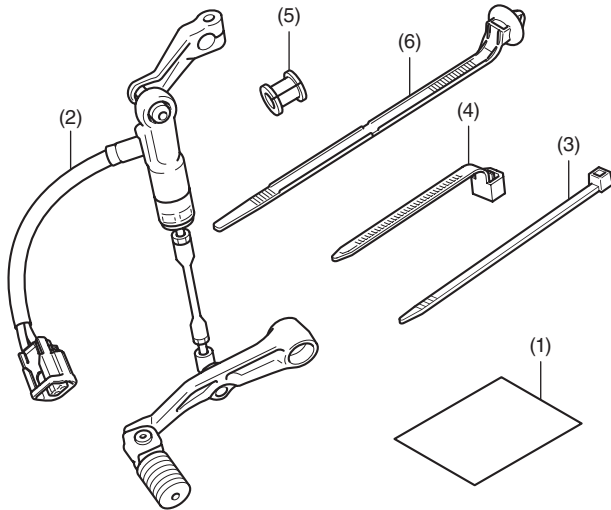

No.	Description	Qty
(1)	URL paper	1
(2)	Gear change pedal	1
(3)	Wire tie (long)	4
(4)	Wire tie (short) (Not used.)	1
(5)	Protector	1
(6)	Clip band (Not used.)	1

TOOL AND SUPPLIES REQUIRED

Nippers
Grease
Electrical tape
Scale
Scissors
Marker
Torque wrench

TORQUE CHART

Refer to the Service Manual for the torque values of the removed parts.

INSTALLATION

▲ CAUTION

- To prevent burns, allow the engine, exhaust system, radiator, etc., to cool before installing the accessory.

NOTE:

- Do not disassemble the gear change pedal.
- Disconnect the negative (-) cable from the battery before installing this accessory.
- The memories of the clock will be erased when you disconnect the battery. Reset the memories after reconnecting the battery.
- Cut the wire tie at 5 mm from the lock part after attaching them to the wire harnesses. Do not allow the cut part of the wire tie to interfere with another harness or brake hose.
- Reinstall the removed parts on the motorcycle and make sure that the wires and harnesses are not pinched.
- Initialization is necessary after installing this accessory.

1. Remove the tool box and disconnect the negative (-) cable of the battery.

<Left side>

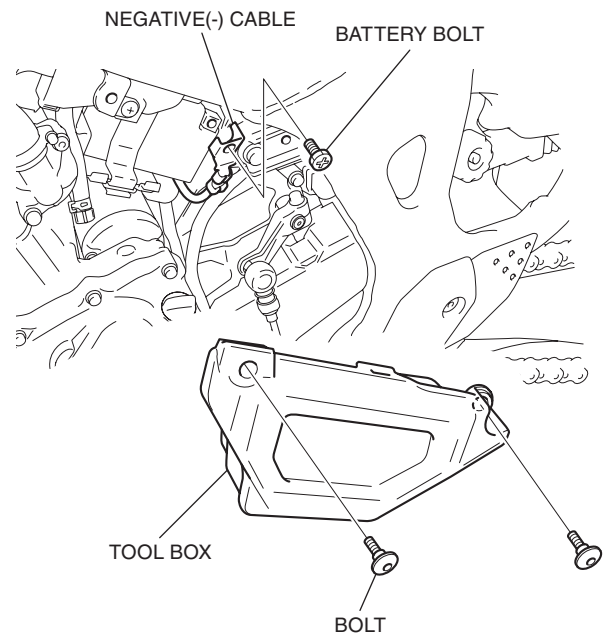

2. Remove the bolts as shown.

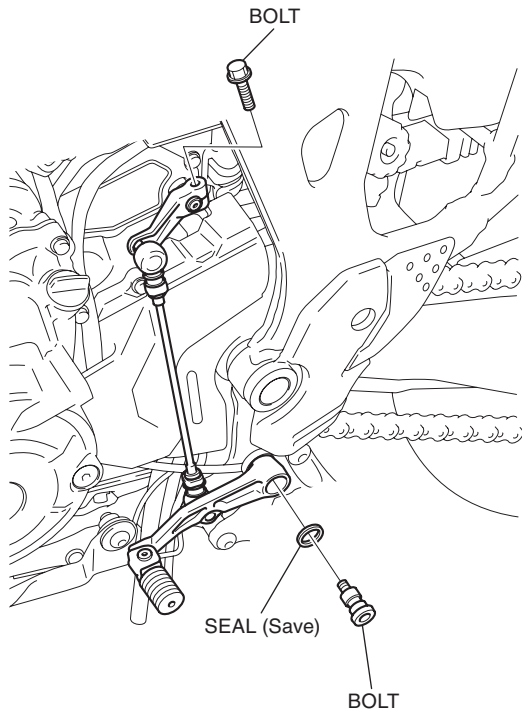

3. Remove the change pedal as shown.

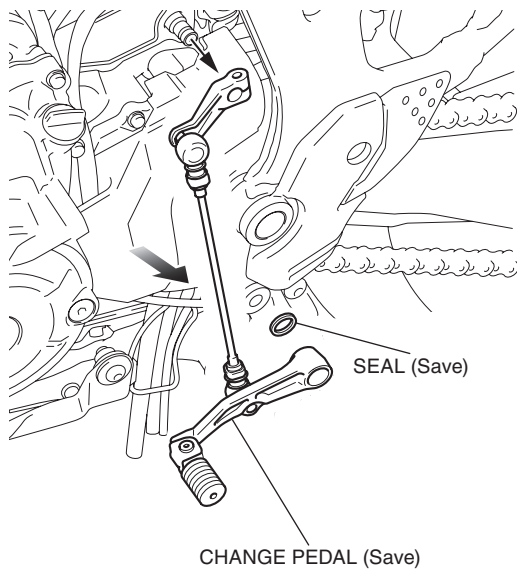

4. Remove the dummy connector as shown.

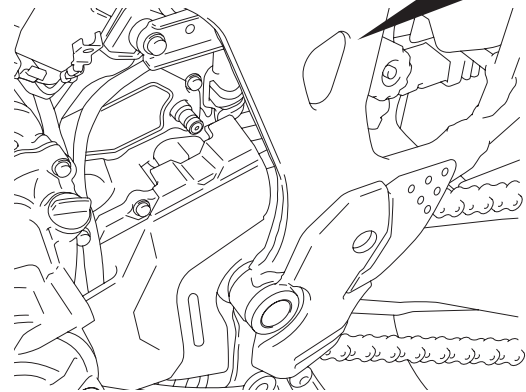
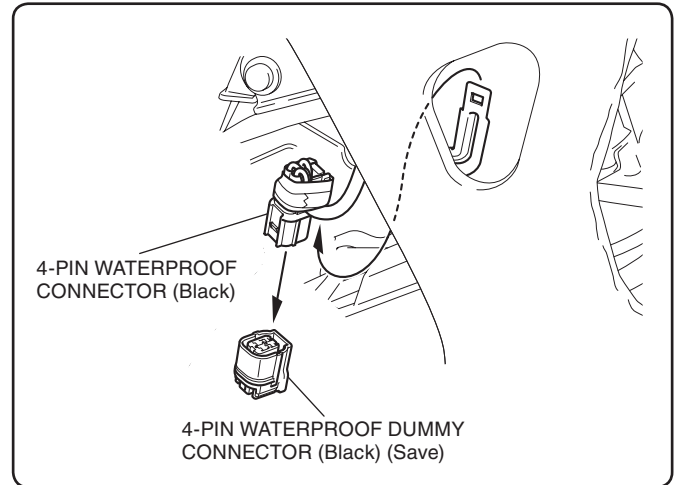

5. Mark the gear change pedal harness at the position of the dimensions shown.

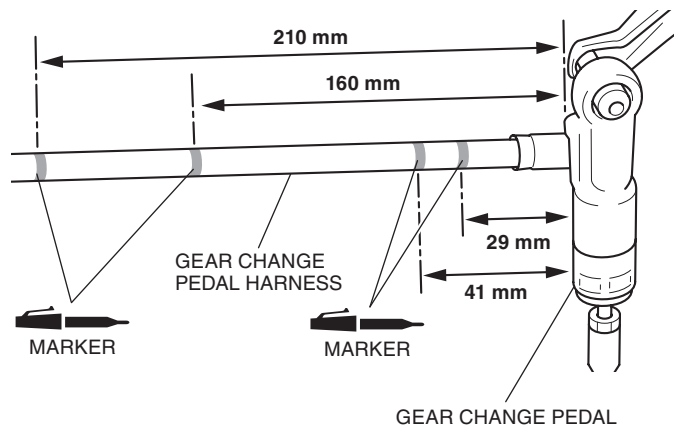

6. Cut the tape as shown location to the indicated dimension.

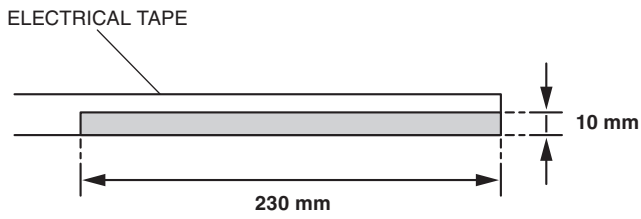

7. Wind the electrical tape as shown.

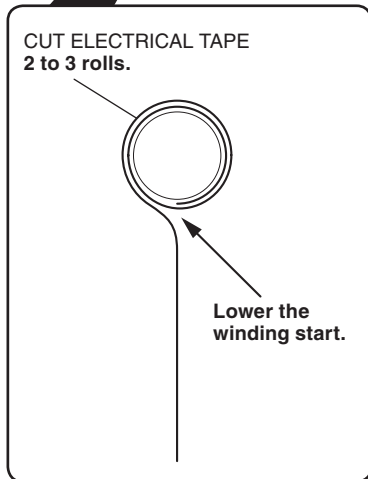
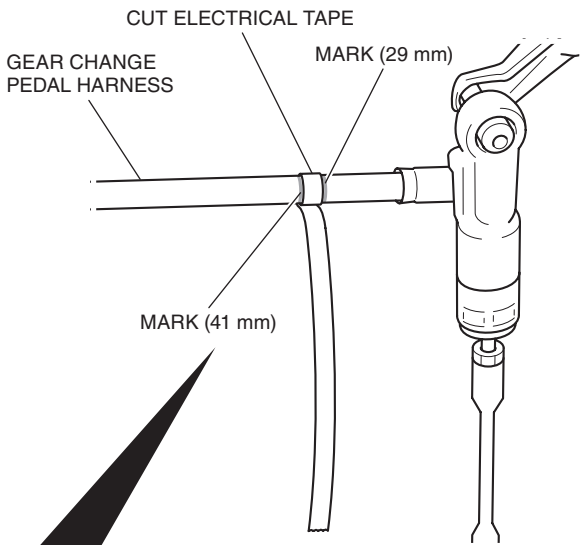

8. Install the protector as shown.

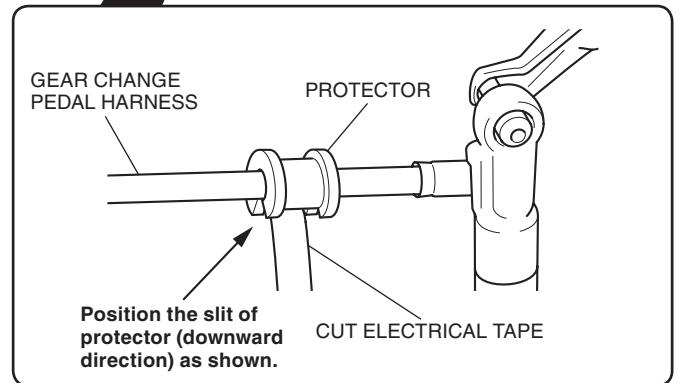
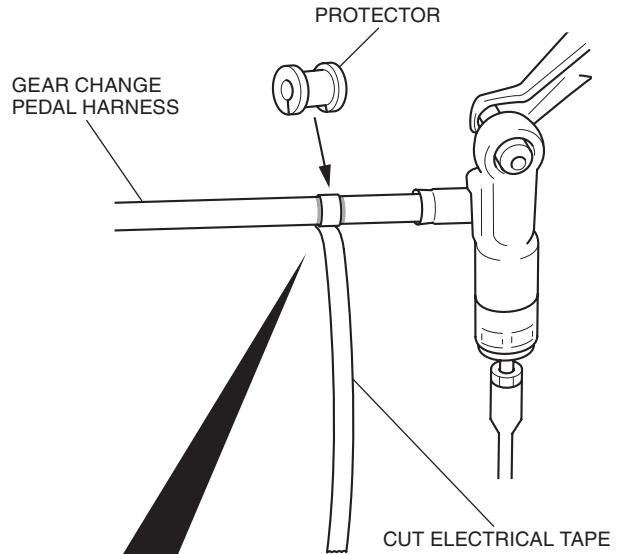

9. Secure the protector with electrical tape as shown.
- Confirm that the secured protector is not off to side.

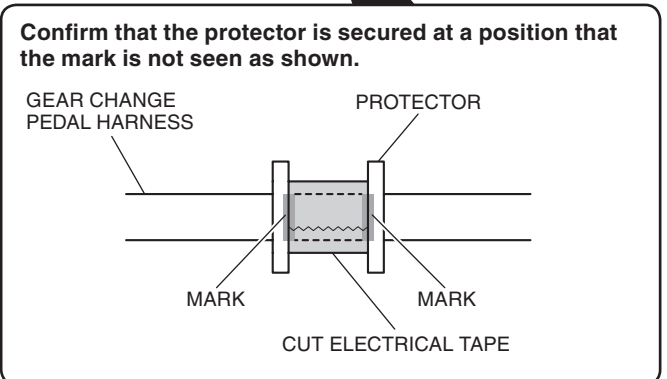
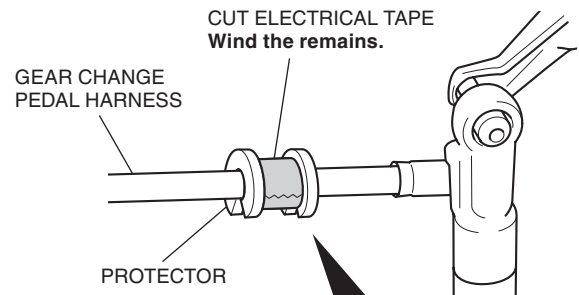

10. Secure the gear change pedal harness with the wire tie as shown.

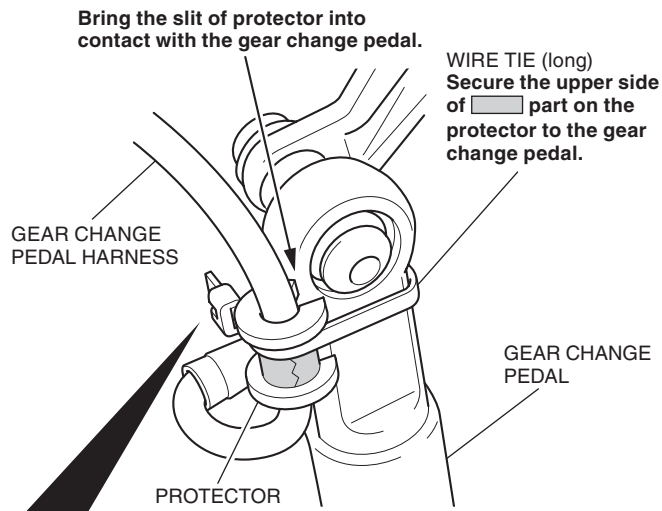

Secure the upper side of [] part with the wire tie as shown.

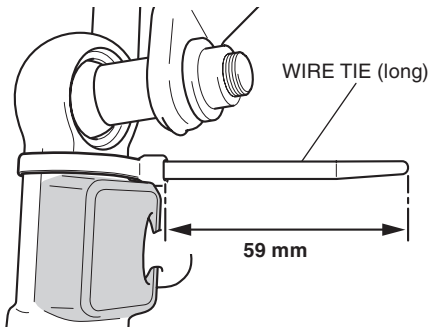

11. Secure the gear change pedal harness in the position of the dimension shown.

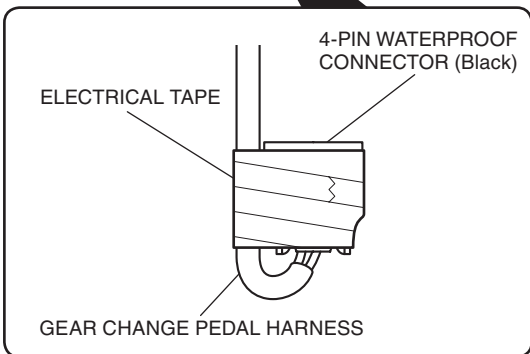
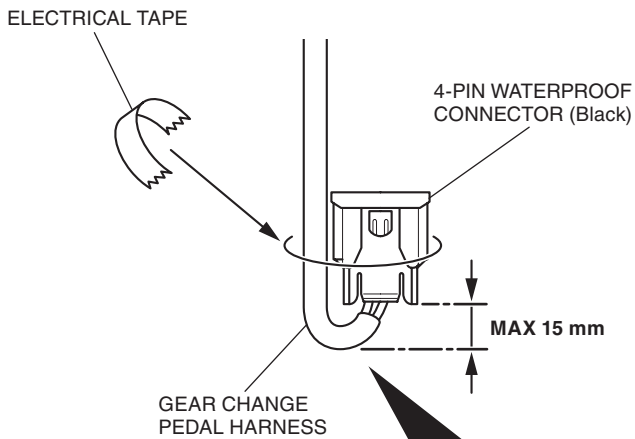

12. Install the gear change pedal as shown.

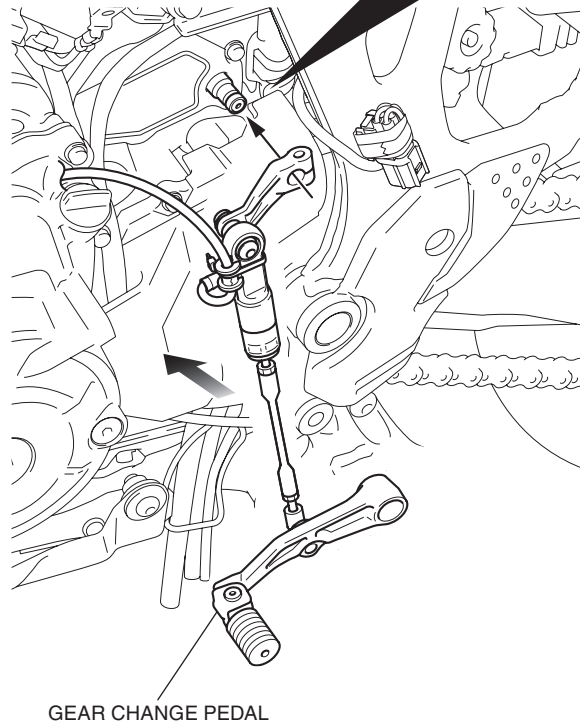
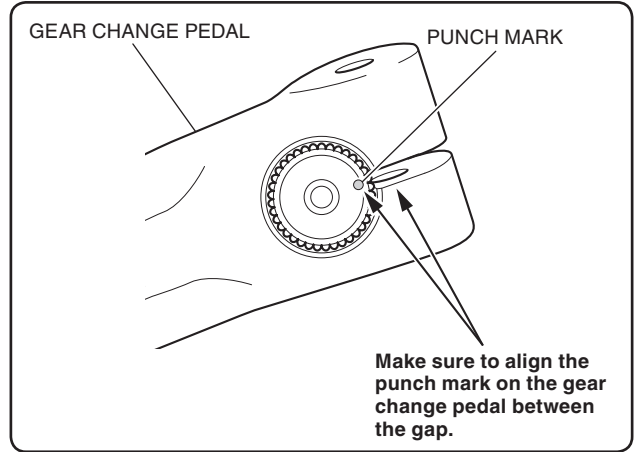

13. Apply grease to the positions shown.

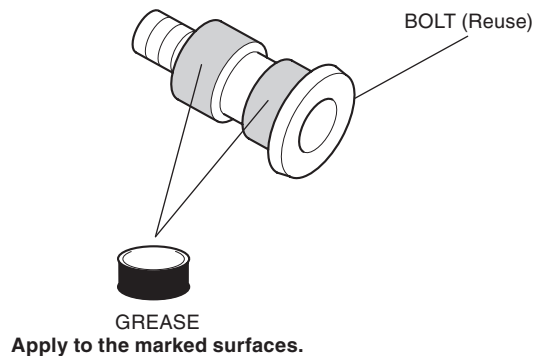

14. Filling grease to the position shown.

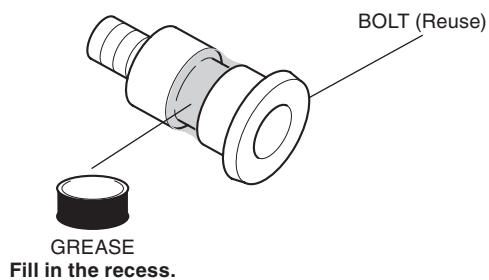

15. Install the bolts as shown.

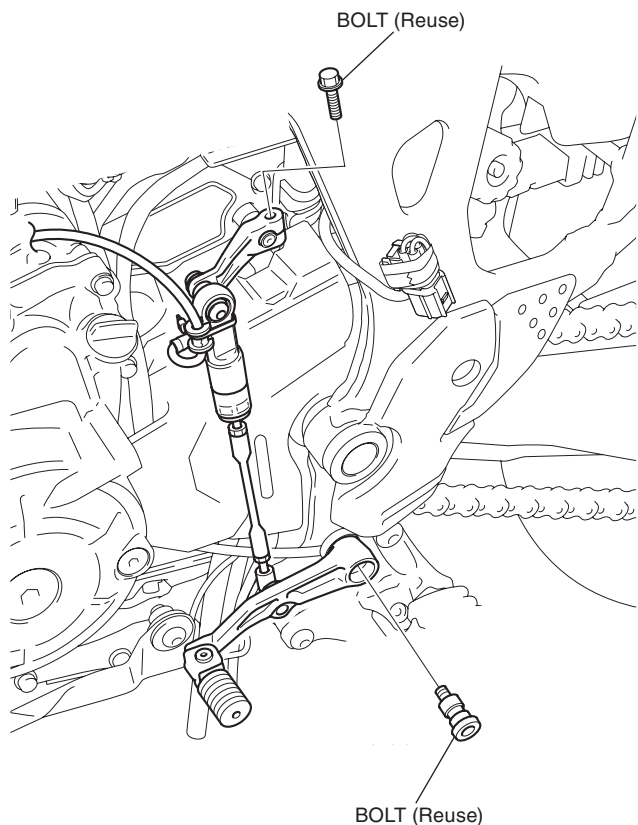

16. Mark at the point of the dimension shown.

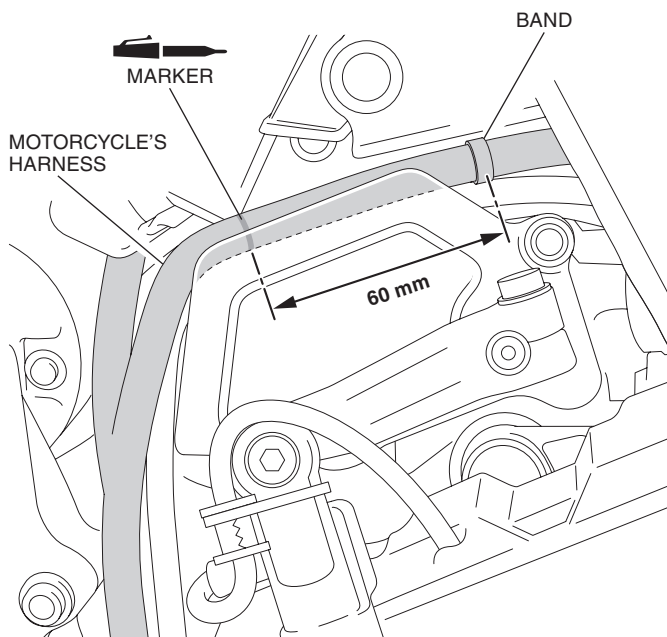

17. Connect the gear change pedal harness as shown.

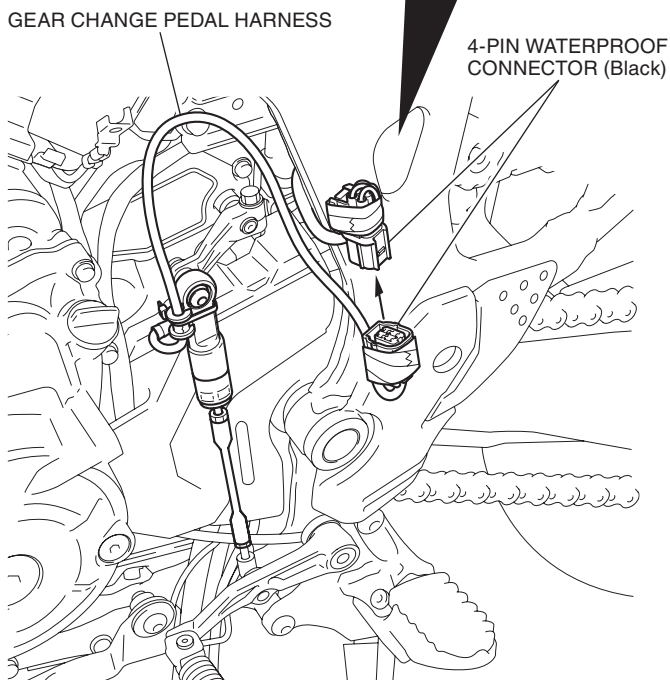
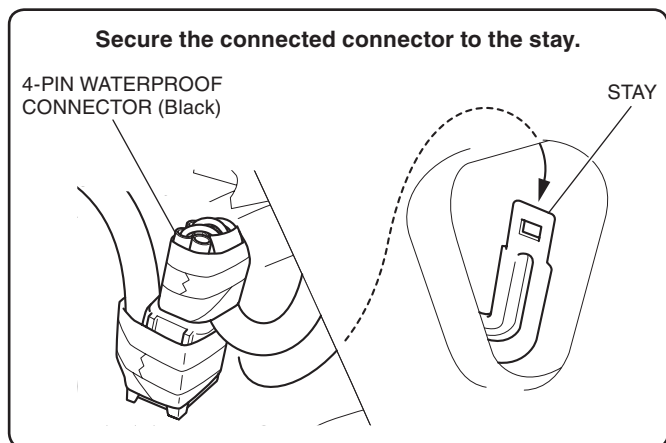

18. Secure the gear change pedal harness with the wire tie as shown.

- **Confirm that the harness is not twisted.**

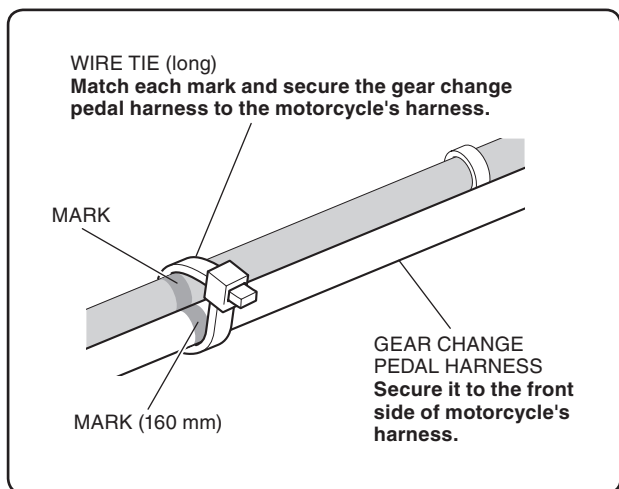

GEAR CHANGE PEDAL HARNESS

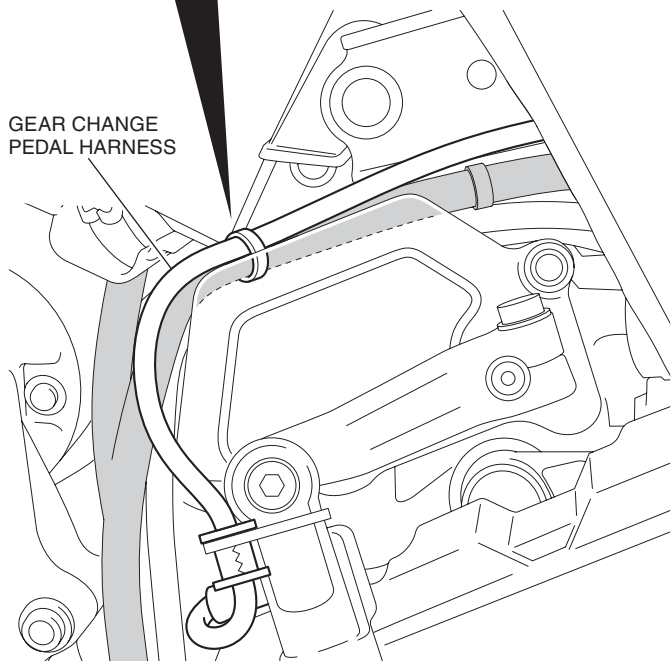

19. Secure the gear change pedal harness with the wire tie as shown.

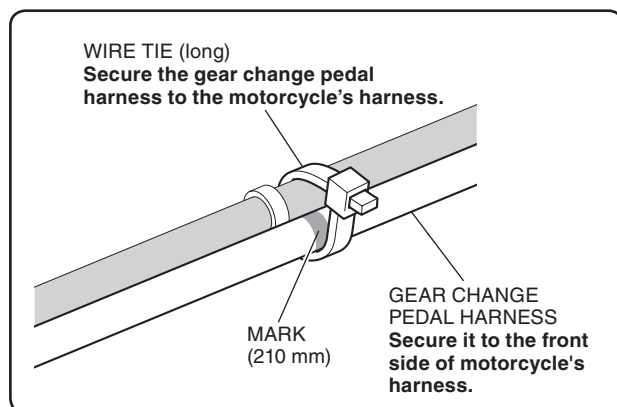

GEAR CHANGE PEDAL HARNESS

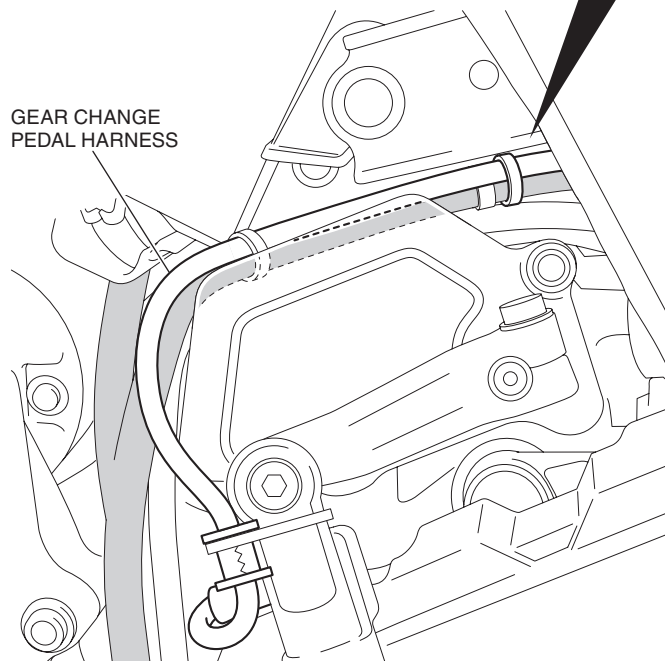

20. Install the motorcycle's parts in the reverse order of removal.

- **Confirm that any wire harness is not caught or too tight.**
- **After installing the quick shifter, perform the initialization.**

21. Check the quick shifter, headlight and the other lights for proper operation.

22. Check the quick shifter, headlight and the other lights for proper operation.
23. Confirm that there is no trapping or cramping of the harness while shifting gears.
24. Confirm that there is no interference of the harness while shifting down.

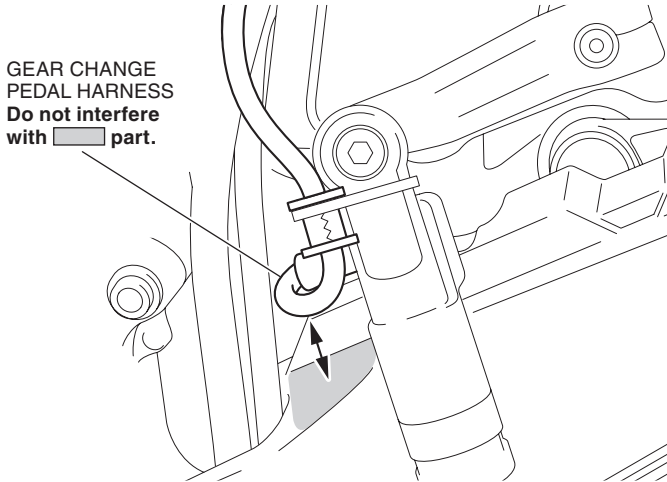

INITIALIZATION INSTRUCTIONS

1. Connect the SCS short connector (070PZ-ZY30100) to the DLC.
2. Turn the ignition switch ON and engine stop switch "Ω".
 - Do not start the engine.
3. Push and hold the MODE and SEL ▲ or SEL ▼ switch.

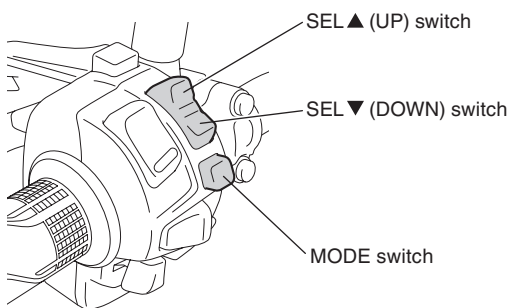

4. Select the "ON". (After removing the quick shifter, select the "OFF".)
 - Select the item with SEL ▲/SEL ▼ switches then decide the item with MODE switch.



5. Select the "YES".

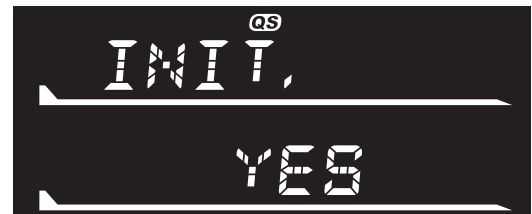

6. The display shows the message the "ENGINE START" then start the engine and let it idle.
 - Shift the transmission to the neutral position then do not touch the pedal.
 - Do not operate the throttle grip.

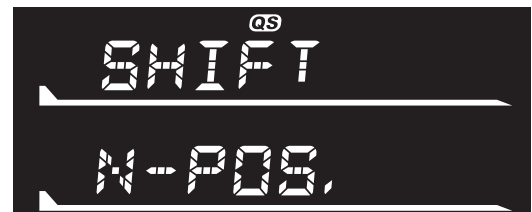
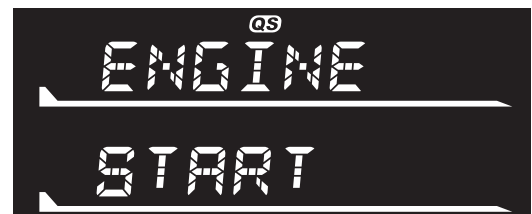

7. Wait for the display shows the message that “OK”.
- If the display shows the message that “NO”, check the mounting conditions of the shift stroke and shift drum angle sensors, then restart the initialization again.

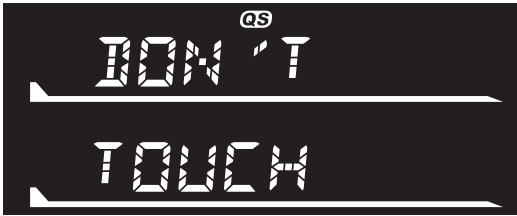

Initialization completion



Initialization failure



8. Turn the ignition switch OFF and remove the SCS short connector.

OPERATING INSTRUCTIONS

This accessory enable the shift change without clutch operation when shifting up and down during acceleration (Engine speed is more than 1,600 rpm on upshifting or more than the idle speed on downshifting).

- If the gear position display is not normal, the shift feeling may change.
- When the shift change do not operate normally, the shift change by clutch operation can be operated.

NOTE:

- For setting the UP LVL or DOWN LVL of the Quick Shifter, refer to the Genuine Accessory User's Guide.